

N 2,012,460

N 2,010,460

N 2,008,460

N 2,006,460

N 2,004,460

N 2,002,460

N 2,000,460

UNLESS DRAWN OTHERWISE, ALL PROPERTIES ARE WITHIN THE FOLLOWING DISTRICTS:

SCHOOL 404001 WATER  
 FIRE SEWER  
 LIGHT AGRICULTURAL

NOTE: A SERIES OF SQUARE OR RECTANGULAR PARCELS (OF LESS THAN ONE ACRE) HAVING TWO OR FOUR EQUAL SIDES ARE USUALLY DIMENSIONED ON THE FIRST AND LAST LINE OF THE SERIES ONLY. ALL THE OTHER PARALLEL LINES IN THIS SERIES OF LOTS ARE TO BE CONSIDERED AS BEING THE SAME LENGTH.

APPROVED BY NEW YORK BOARD OF EQUALIZATION AND ASSESSMENT

CASE NO. 1549 J TAGGART (AUTHORIZED SIGNATURE) JUNE 8, 1979

E. 232,000

E. 233,000

E. 236,000

E. 239,000

E. 242,000

E. 245,000

### NOTICE OF DISCLAIMER

This map represents a compilation of graphical and textual information from deeds and surveys, a planimetric base map, and digital conversions of hand drawn mylar maps. Errors and omissions can occur from each of these sources; each source represents a large number of records and originators of information. As a practical matter, the County does not warrant the accuracy or completeness of the information portrayed. The end user of these maps agrees to accept the data "as is" with the full knowledge that errors and omissions may exist, and to hold harmless the County for any damages that may result from an inappropriate use of these maps.

### DRAWING LEGEND

International Boundary  
 County Boundary  
 Town Boundary  
 Village Boundary  
 Property or R/W Line

Denotes Common Owner  
 Railroad  
 Water  
 Block Limit Line  
 Special District Line  
 Subdivision Lot Line

Block No. 1  
 Parcel No. 27  
 Subdivision Lot No. (10)  
 Deed Dimension 112'  
 Scaled Dimension 27'  
 Deed Area (27.3)  
 Calculated Area 148.2A(c)

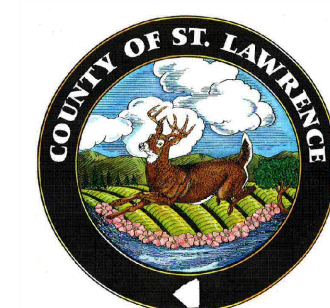

ST. LAWRENCE COUNTY  
 NEW YORK  
 REAL PROPERTY  
 COUNTY OFFICE BUILDING  
 CANTON, NEW YORK 13617  
 (315) 379-2272 OFFICE  
 (315) 229-3222 FAX

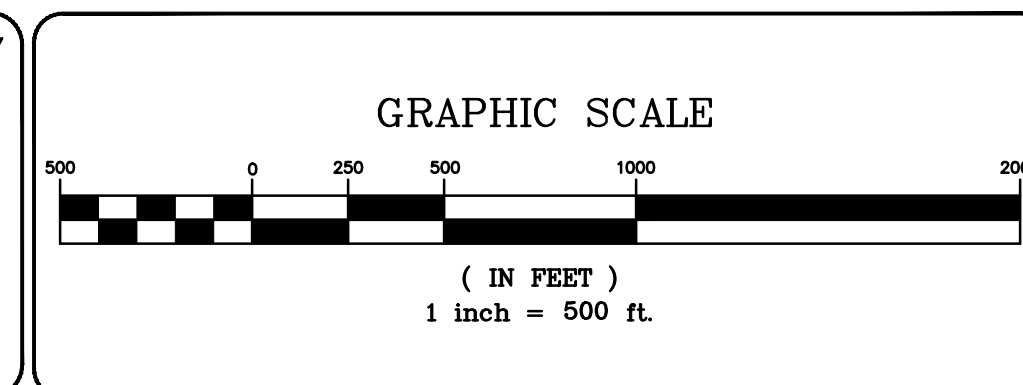

7			
6			
5			
4			
3			
2			
1			
REVISIONS		DATE	BY

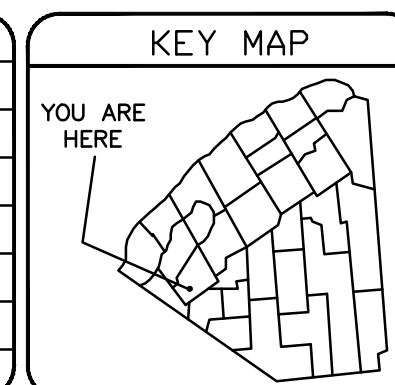

TOWN OF: **GOVERNEUR**  
 VILLAGE OF: **GOVERNEUR**  
 DISTRICT NO.: **404001**  
 Date of Conversion: 12/19/06 JIM

SECTION NO.  
**INDEX**  
 PROPERTY MAP

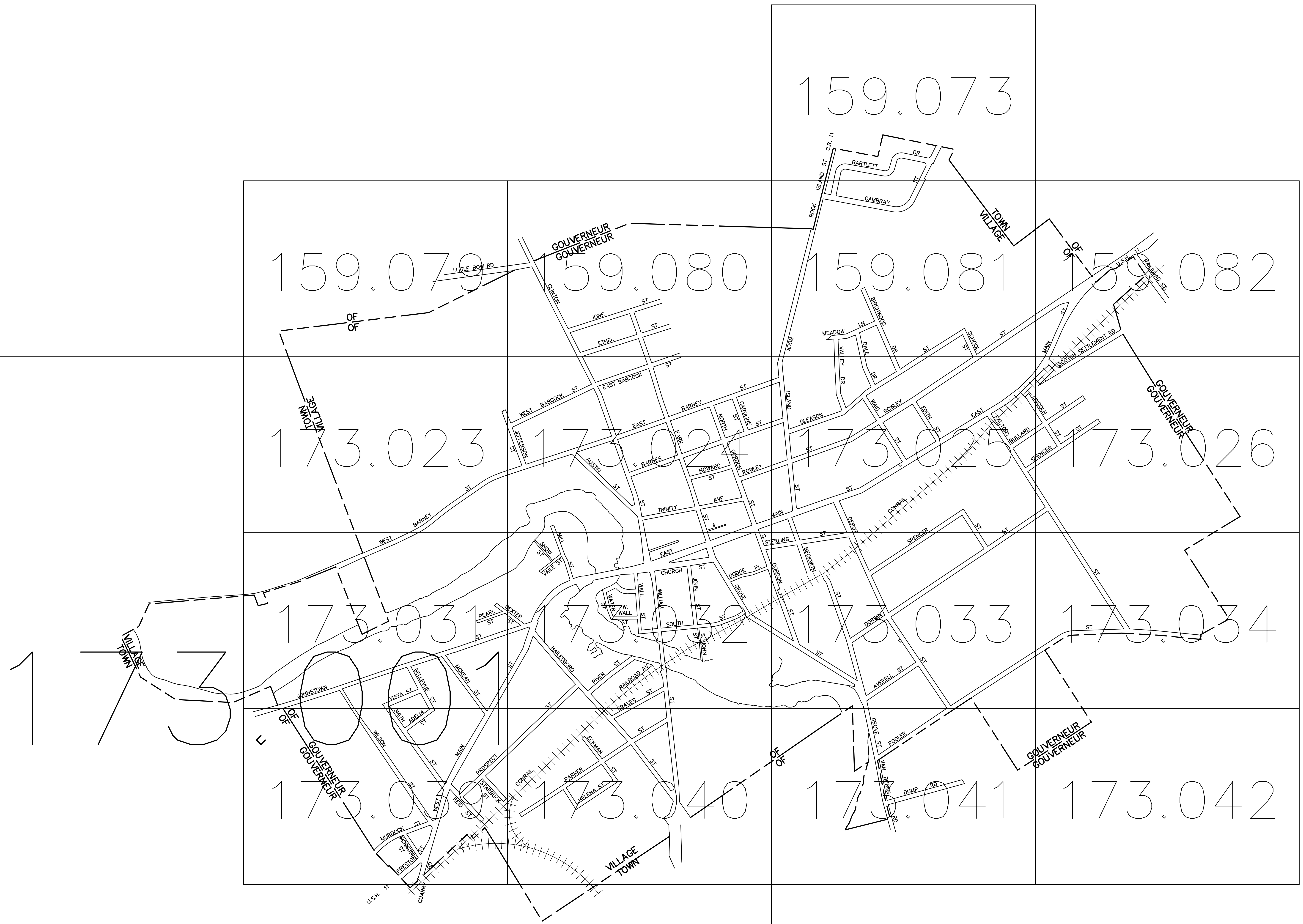

THIS MAP WAS PREPARED FOR TAX PURPOSES ONLY  
 NOT TO BE USED FOR CONVEYANCE