

DUE TO SPACE CONSTRAINTS, NOT ALL THE PRIVATE ROADS ARE DRAWN ON THIS INDEX MAP. THE FOLLOWING IS A LIST OF ALL THE PRIVATE ROADS, AND THE CORRESPONDING SECTION NUMBER WHERE IT IS LOCATED.

- 1) BACKUS CAMP RD 86.002
- 2) BARR RD 70.003 & 70.053
- 3) CAMP RD 41 70.003 & 70.053
- 4) LIVINGSTON DRIVE 70.003 & 70.053
- 5) HELL'S RD (PVT) 70.003 & 70.053
- 6) WRIGHT CAMP DR (PVT) 70.003 & 70.053
- 7) CHARDONWAY 70.003, 70.045, 70.046 & 70.001
- 8) COUNTRY CLUB SHORES RD WEST 70.038
- 9) MCEWEN LN (PVT) 70.001
- 10) LORD DR (PVT) 70.024
- 11) VIEWPOINT LANE 70.024
- 12) BASTA BLVD. 58.081
- 13) PECCOLO DR (PVT) 58.058 & 58.059
- 14) BRIGGS STREET 58.051
- 15) PEO'S LN (PVT) 58.051
- 16) KLONDKE RD (PVT) 58.043 & 58.051
- 17) CEDAR CROFT 70.024
- 18) CEDAR SHORES 58.051
- 19) COUNTRY CLUB SHORES RD 70.038
- 20) DUNN POINT RD 70.038 & 70.046
- 21) EEL WEIR DR. 71.001
- 22) FELL FARM RD. 70.001, 70.023 & 70.024
- 23) MEMORY LN (PVT) 84.004
- 24) CRYSTAL LN (PVT) 85.003
- 25) RIFA RD (PVT) 58.059
- 26) ROCK RD 85.001
- 27) WILSON LN (PVT) 71.001
- 28) LEE DR. 71.001, 71.048 & 71.003
- 29) FERRY RD. 70.025
- 30) RIVER LN. 71.001, 71.048 & 71.003
- 31) SWANS SHORE RD. 59.003
- 32) STONE HEDGE LN. 58.051
- 33) ZOWLAR RD. 85.039
- 34) BUSBY LN (PVT) 70.001
- 35) HOWES PINE VIEW LN (PVT) 71.001 & 71.048
- 36) SLEEPY HOLLOW LN (PVT) 59.003

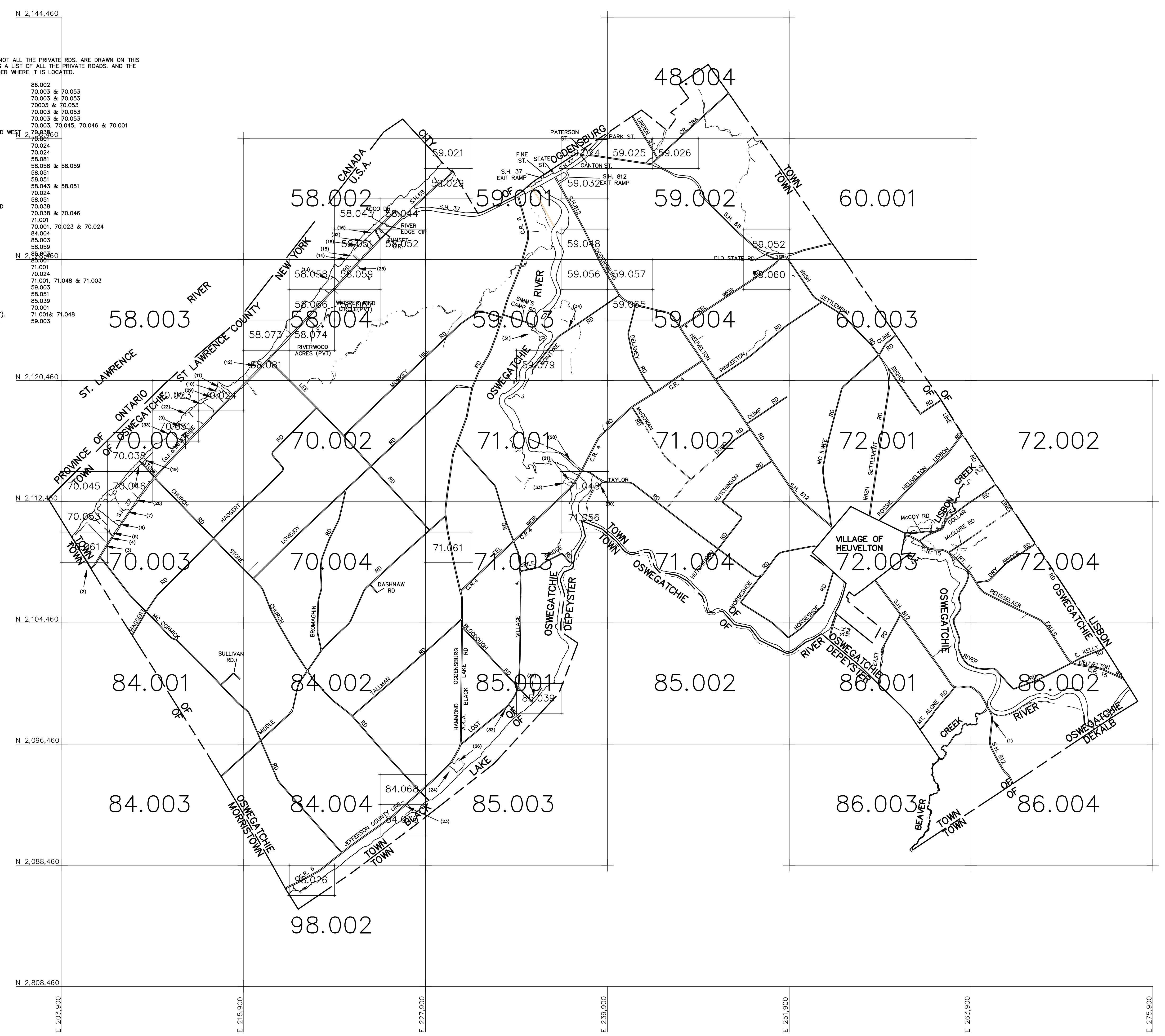

NOTE: A SERIES OF SQUARE OR RECTANGULAR PARCELS (OF LESS THAN ONE ACRE) HAVING TWO OR FOUR EQUAL SIDES ARE USUALLY DIMENSIONED ON THE FIRST AND LAST LINE OF THE SERIES ONLY. ALL THE OTHER PARALLEL LINES IN THIS SERIES OF LOTS ARE TO BE CONSIDERED AS BEING THE SAME LENGTH.

APPROVED BY NEW YORK BOARD OF EQUALIZATION AND ASSESSMENT
 CASE NO. 1549 J TAGGART (AUTHORIZED SIGNATURE)
 JUNE 8, 1979

THIS MAP WAS PREPARED FOR TAX PURPOSES ONLY
 NOT TO BE USED FOR CONVEYANCE

<p>NOTICE OF DISCLAIMER</p> <p>This map represents a compilation of graphical and textual information from deeds and surveys, a planimetric base map, and digital conversions of hand drawn mylar maps. Errors and omissions can occur from each of these sources; each source represents a large number of records and originators of information. As a practical matter, the County does not warrant the accuracy or completeness of the information portrayed. The end user of these maps agrees to accept the data "as is" with the full knowledge that errors and omissions may exist, and to hold harmless the County for any damages that may result from an inappropriate use of these maps.</p>	<p>DRAWING LEGEND</p> <table style="width: 100%; border: none;"> <tr> <td style="border: none;">International Boundary</td> <td style="border: none;">Denotes Common Owner</td> <td style="border: none;">Z</td> </tr> <tr> <td style="border: none;">County Boundary</td> <td style="border: none;">Railroad</td> <td style="border: none;">Block No.</td> </tr> <tr> <td style="border: none;">Town Boundary</td> <td style="border: none;">Water</td> <td style="border: none;">Parcel No.</td> </tr> <tr> <td style="border: none;">Village Boundary</td> <td style="border: none;">Block Limit Line</td> <td style="border: none;">Subdivision Lot No.</td> </tr> <tr> <td style="border: none;">Property or R/W Line</td> <td style="border: none;">Special District Line</td> <td style="border: none;">Deed Dimension</td> </tr> <tr> <td></td> <td style="border: none;">Subdivision Lot Line</td> <td style="border: none;">Scaled Dimension</td> </tr> <tr> <td></td> <td></td> <td style="border: none;">Deed Area</td> </tr> <tr> <td></td> <td></td> <td style="border: none;">Calculated Area</td> </tr> </table>	International Boundary	Denotes Common Owner	Z	County Boundary	Railroad	Block No.	Town Boundary	Water	Parcel No.	Village Boundary	Block Limit Line	Subdivision Lot No.	Property or R/W Line	Special District Line	Deed Dimension		Subdivision Lot Line	Scaled Dimension			Deed Area			Calculated Area	<p style="text-align: center;">ST. LAWRENCE COUNTY NEW YORK REAL PROPERTY</p> <p style="text-align: center;">COUNTY OFFICE BUILDING CANTON, NEW YORK 13617 (315) 379-2272 OFFICE (315) 229-3222 FAX</p>	<p style="text-align: center;">GRAPHIC SCALE</p> <p style="text-align: center;">(IN FEET) 1 inch = 3000ft.</p>	<p style="text-align: center;">KEY MAP</p>	<table border="1" style="width: 100%; border-collapse: collapse;"> <tr> <td style="text-align: center;">7</td> <td></td> <td></td> <td></td> </tr> <tr> <td style="text-align: center;">6</td> <td></td> <td></td> <td></td> </tr> <tr> <td style="text-align: center;">5</td> <td></td> <td></td> <td></td> </tr> <tr> <td style="text-align: center;">4</td> <td></td> <td></td> <td></td> </tr> <tr> <td style="text-align: center;">3</td> <td></td> <td></td> <td></td> </tr> <tr> <td style="text-align: center;">2</td> <td></td> <td></td> <td></td> </tr> <tr> <td style="text-align: center;">1</td> <td></td> <td></td> <td></td> </tr> <tr> <td style="text-align: center;">REVISIONS</td> <td style="text-align: center;">DATE</td> <td style="text-align: center;">BY</td> <td></td> </tr> </table>	7				6				5				4				3				2				1				REVISIONS	DATE	BY		<p style="text-align: center;">SECTION NO.</p> <p style="text-align: center; font-size: 2em; font-weight: bold;">INDEX</p> <p style="text-align: center;">PROPERTY MAP</p>
International Boundary	Denotes Common Owner	Z																																																												
County Boundary	Railroad	Block No.																																																												
Town Boundary	Water	Parcel No.																																																												
Village Boundary	Block Limit Line	Subdivision Lot No.																																																												
Property or R/W Line	Special District Line	Deed Dimension																																																												
	Subdivision Lot Line	Scaled Dimension																																																												
		Deed Area																																																												
		Calculated Area																																																												
7																																																														
6																																																														
5																																																														
4																																																														
3																																																														
2																																																														
1																																																														
REVISIONS	DATE	BY																																																												
					<p>TOWN OF: OSWEGATCHIE</p> <p>DISTRICT NO.: 406489</p> <p>Date of Conversion: 11/1/2010 LDC</p>																																																									