

N 1,992,460  
E 371,900



TOWN OF MOOSEHEAD  
MOOSEHEAD POND OUTLET  
N 1,976,460  
E 371,900

UNLESS DRAWN OTHERWISE, ALL PROPERTIES ARE WITHIN THE FOLLOWING DISTRICTS:  
SCHOOL 402601 WATER  
FIRE 192016 SEWER  
LIGHT AGRICULTURAL

THIS MAP WAS PREPARED FOR TAX PURPOSES ONLY  
NOT TO BE USED FOR CONVEYANCE

**NOTICE OF DISCLAIMER**  
This map represents a compilation of graphical and textual information from deeds and surveys, a planimetric base map, and digital conversions of hand drawn mylar maps. Errors and omissions can occur from each of these sources; each source represents a large number of records and originators of information. As a practical matter, the County does not warrant the accuracy or completeness of the information portrayed. The end user of these maps agrees to accept the data "as is" with the full knowledge that errors and omissions may exist, and to hold harmless the County for any damages that may result from an inappropriate use of these maps.

**DRAWING LEGEND**  
International Boundary  
County Boundary  
Town Boundary  
Village Boundary  
Property or R/W Line  
Denotes Common Owner  
Railroad  
Water  
Block Limit Line  
Special District Line  
Subdivision Lot Line

Block No. 1  
Parcel No. 27  
Subdivision Lot No. (10)  
Deed Dimension 112'  
Scaled Dimension 27'  
Deed Area (27.3)  
Calculated Area 148.2A(c)

ST. LAWRENCE COUNTY  
NEW YORK  
REAL PROPERTY  
COUNTY OFFICE BUILDING  
CANTON, NEW YORK 13617  
(315) 379-2272 OFFICE  
(315) 229-3222 FAX

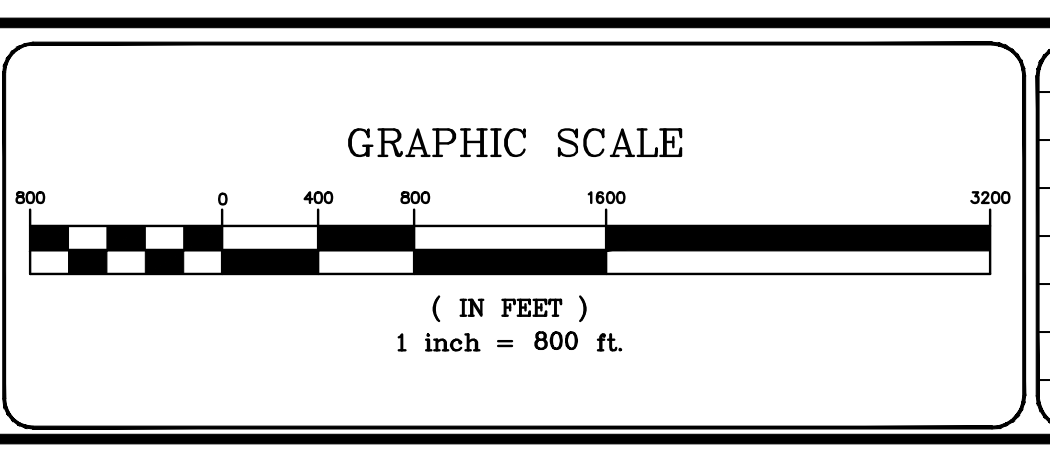

NO.	REVISIONS	DATE	BY
7			
6			
5			
4			
3			
2			
1			

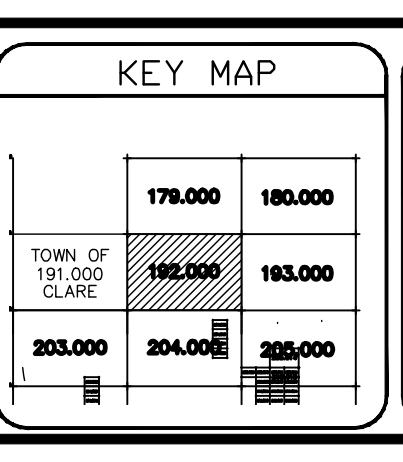

TOWN OF: CLIFTON  
DISTRICT NO.: 402600  
Date of Conversion: 8/6/2008 MRP

SECTION NO.  
192.000  
PROPERTY MAP