

UNLESS DRAWN OTHERWISE, ALL PROPERTIES ARE WITHIN THE FOLLOWING DISTRICTS :

SCHOOL	185401	WATER	---
FIRE	15579	SEWER	---
LIGHT	---	AGRICULTURAL	---

**NOTICE OF DISCLAIMER**

This map represents a compilation of graphical and textual information from deeds and surveys, a planimetric base map, and digital conversions of hand drawn mylar maps. Errors and omissions can occur from each of these sources; each source represents a large number of records and originators of information. As a practical matter, the County does not warrant the accuracy or completeness of the information portrayed. The end user of these maps agrees to accept the data "as is" with the full knowledge that errors and omissions may exist, and to hold harmless the County for any damages that may result from an inappropriate use of these maps.

**DRAWING LEGEND**

International Boundary	---	Denotes Common Owner Railroad	①
County Boundary	---	Water	27
Town Boundary	---	Block Limit Line	112'
Village Boundary	---	Special District Line	27'
Property or R/W Line	---	Subdivision Lot Line	(27'-2.1')
		Block No.	148.2A(c)
		Parcel No.	
		Subdivision Lot No.	
		Deed Dimension	
		Scaled Dimension	
		Deed Area	
		Calculated Area	



**ST. LAWRENCE COUNTY**  
**NEW YORK**  
**REAL PROPERTY**  
 COUNTY OFFICE BUILDING  
 CANTON, NEW YORK 13617  
 (315) 379-2272 OFFICE  
 (315) 229-3222 FAX

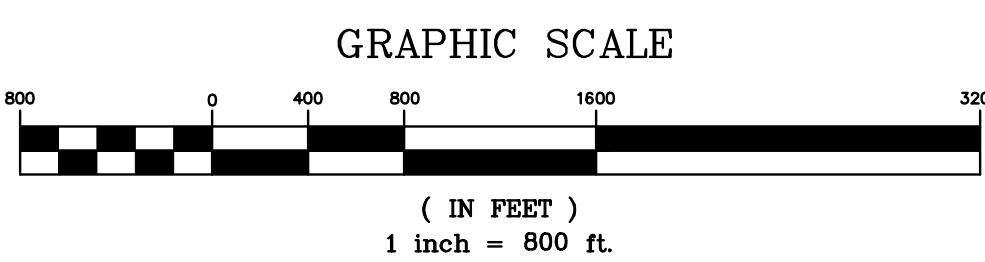

7			
6			
5			
4			
3			
2			
1			
	REVISIONS	DATE	BY

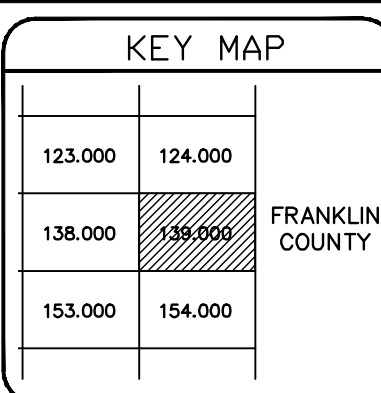

TOWN OF:	<b>HOPKINTON</b>
DISTRICT NO.:	<b>404600</b>
Date of Conversion	03/01/08 LDC

SECTION NO.	<b>139.000</b>
PROPERTY MAP	

THIS MAP WAS PREPARED FOR TAX PURPOSES ONLY  
 NOT TO BE USED FOR CONVEYANCE