

E 263,900

PROVINCE OF ONTARIO  
TOWN OF LISBON, ST. LAWRENCE COUNTY

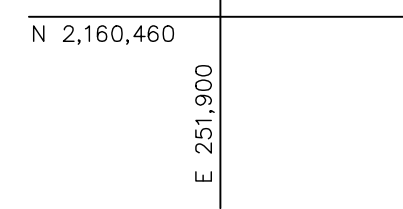

CANADA  
U.S.A.  
LISBON

MATCH LINE  
ALSO SEE 38.003

NEW YORK STATE POWER AUTHORITY

MATCH LINE  
ALSO SEE 38.002

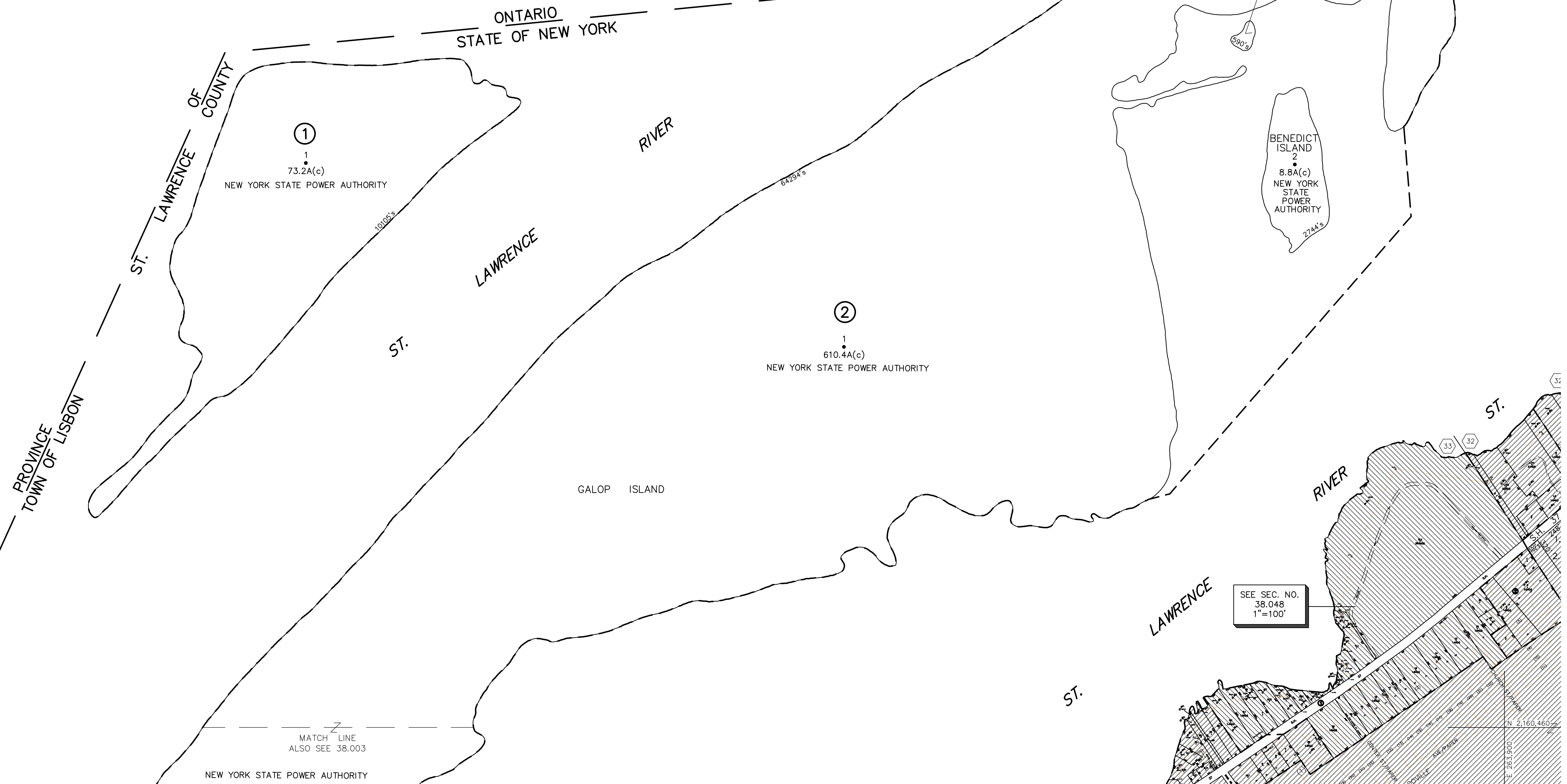

SEE SEC. NO.  
38.048  
1"=100'

UNLESS DRAWN OTHERWISE, ALL PROPERTIES ARE WITHIN THE FOLLOWING DISTRICTS:

SCHOOL 405002 WATER  
FIRE 75001 SEWER  
LIGHT 75001 AGRICULTURAL

THIS MAP WAS PREPARED FOR TAX PURPOSES ONLY  
NOT TO BE USED FOR CONVEYANCE

**NOTICE OF DISCLAIMER**

This map represents a compilation of graphical and textual information from deeds and surveys, a planimetric base map, and digital conversions of hand drawn mylar maps. Errors and omissions can occur from each of these sources; each source represents a large number of records and originators of information. As a practical matter, the County does not warrant the accuracy or completeness of the information portrayed. The end user of these maps agrees to accept the data "as is" with the full knowledge that errors and omissions may exist, and to hold harmless the County for any damages that may result from an inappropriate use of these maps.

**DRAWING LEGEND**

International Boundary  
County Boundary  
Town Boundary  
Village Boundary  
Property or R/W Line

Denotes Common Owner  
Water  
Block Limit Line  
Special District Line  
Subdivision Lot Line

Block No. ①  
Parcel No. 27  
Subdivision Lot No. (10)  
Deed Dimension 112'  
Scaled Dimension 27'  
Deed Area (27.3)  
Calculated Area 148.2A(c)

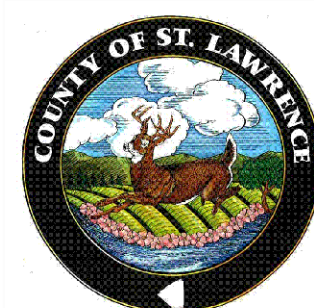

ST. LAWRENCE COUNTY  
NEW YORK  
REAL PROPERTY  
COUNTY OFFICE BUILDING  
CANTON, NEW YORK 13617  
(315) 379-2272 OFFICE  
(315) 229-3222 FAX

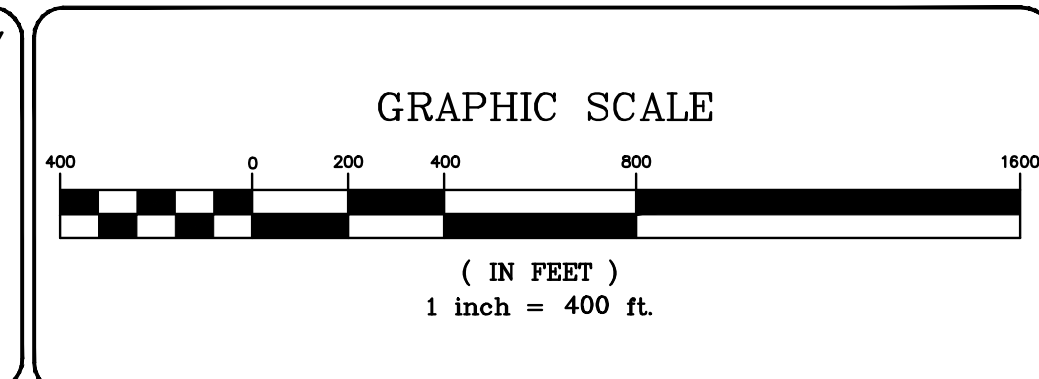

7			
6			
5			
4			
3			
2			
1			
REVISIONS		DATE	BY

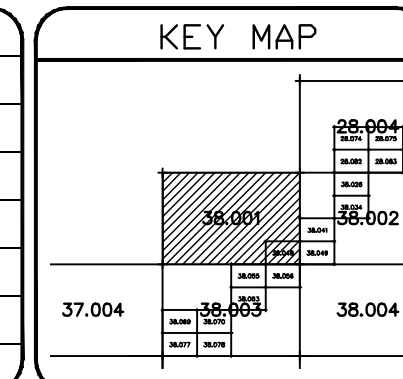

TOWN OF: LISBON  
DISTRICT NO.: 405000  
Date of Conversion: 2/5/2010 MRP

SECTION NO.  
38.001  
PROPERTY MAP