

S. H.

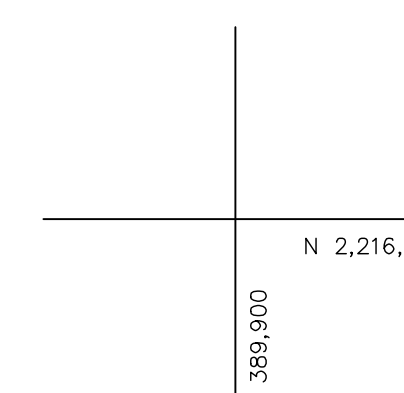
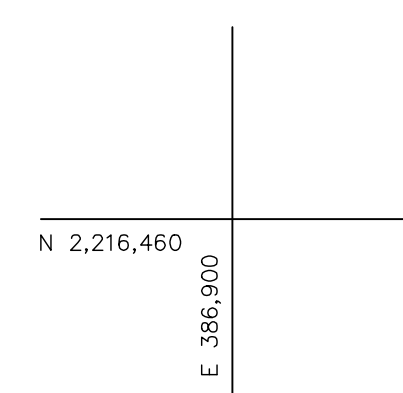
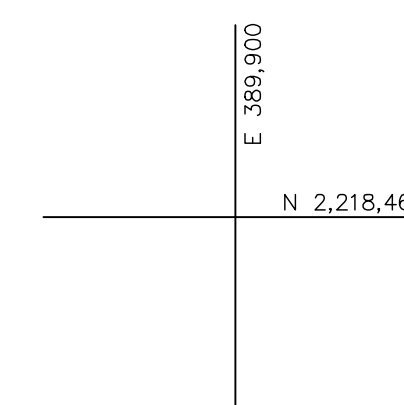

UNLESS DRAWN OTHERWISE, ALL PROPERTIES ARE WITHIN THE FOLLOWING DISTRICTS :

SCHOOL 405201 WATER
 FIRE SENECA
 LIGHT AGRICULTURAL

THIS MAP WAS PREPARED FOR TAX PURPOSES ONLY
 NOT TO BE USED FOR CONVEYANCE

<p>NOTICE OF DISCLAIMER</p> <p>This map represents a compilation of graphical and textual information from deeds and surveys, a planimetric base map, and digital conversions of hand drawn mylar maps. Errors and omissions can occur from each of these sources; each source represents a large number of records and originators of information. As a practical matter, the County does not warrant the accuracy or completeness of the information portrayed. The end user of these maps agrees to accept the data "as is" with the full knowledge that errors and omissions may exist, and to hold harmless the County for any damages that may result from an inappropriate use of these maps.</p>	<p>DRAWING LEGEND</p> <table style="width:100%; border: none;"> <tr> <td style="border: none;">International Boundary</td> <td style="border: none;">—————</td> <td style="border: none;">Denotes Common Owner</td> <td style="border: none;">—————</td> </tr> <tr> <td style="border: none;">County Boundary</td> <td style="border: none;">—————</td> <td style="border: none;">Railroad</td> <td style="border: none;">—————</td> </tr> <tr> <td style="border: none;">Town Boundary</td> <td style="border: none;">—————</td> <td style="border: none;">Water</td> <td style="border: none;">—————</td> </tr> <tr> <td style="border: none;">Village Boundary</td> <td style="border: none;">—————</td> <td style="border: none;">Block Limit Line</td> <td style="border: none;">—————</td> </tr> <tr> <td style="border: none;">Property or R/W Line</td> <td style="border: none;">—————</td> <td style="border: none;">Special District Line</td> <td style="border: none;">—————</td> </tr> <tr> <td style="border: none;"></td> <td style="border: none;"></td> <td style="border: none;">Subdivision Lot Line</td> <td style="border: none;">—————</td> </tr> </table>	International Boundary	—————	Denotes Common Owner	—————	County Boundary	—————	Railroad	—————	Town Boundary	—————	Water	—————	Village Boundary	—————	Block Limit Line	—————	Property or R/W Line	—————	Special District Line	—————			Subdivision Lot Line	—————	<table style="width:100%; border: none;"> <tr> <td style="border: none;">Block No.</td> <td style="border: none;">①</td> </tr> <tr> <td style="border: none;">Parcel No.</td> <td style="border: none;">27</td> </tr> <tr> <td style="border: none;">Subdivision Lot No.</td> <td style="border: none;">(10)</td> </tr> <tr> <td style="border: none;">Deed Dimension</td> <td style="border: none;">112'</td> </tr> <tr> <td style="border: none;">Scaled Dimension</td> <td style="border: none;">27'±</td> </tr> <tr> <td style="border: none;">Deed Area</td> <td style="border: none;">(27.3±)</td> </tr> <tr> <td style="border: none;">Calculated Area</td> <td style="border: none;">148.2A(c)</td> </tr> </table>	Block No.	①	Parcel No.	27	Subdivision Lot No.	(10)	Deed Dimension	112'	Scaled Dimension	27'±	Deed Area	(27.3±)	Calculated Area	148.2A(c)	<p>ST. LAWRENCE COUNTY NEW YORK REAL PROPERTY COUNTY OFFICE BUILDING CANTON, NEW YORK 13617 (315) 379-2272 OFFICE (315) 229-3222 FAX</p>	<p>GRAPHIC SCALE</p> <p>(IN FEET) 1 inch = 100 ft.</p>	<table border="1" style="width:100%; border-collapse: collapse;"> <tr><td style="text-align: center;">7</td><td></td><td></td><td></td></tr> <tr><td style="text-align: center;">6</td><td></td><td></td><td></td></tr> <tr><td style="text-align: center;">5</td><td></td><td></td><td></td></tr> <tr><td style="text-align: center;">4</td><td></td><td></td><td></td></tr> <tr><td style="text-align: center;">3</td><td></td><td></td><td></td></tr> <tr><td style="text-align: center;">2</td><td></td><td></td><td></td></tr> <tr><td style="text-align: center;">1</td><td></td><td></td><td></td></tr> <tr><td colspan="2" style="text-align: center;">REVISIONS</td><td style="text-align: center;">DATE</td><td style="text-align: center;">BY</td></tr> </table>	7				6				5				4				3				2				1				REVISIONS		DATE	BY	<p>KEY MAP</p>	<table style="width:100%; border: none;"> <tr> <td style="border: none;">TOWN OF:</td> <td style="border: none;">LOUISVILLE</td> </tr> <tr> <td style="border: none;">VILLAGE OF:</td> <td style="border: none;">MASSENA</td> </tr> <tr> <td style="border: none;">DISTRICT NO.:</td> <td style="border: none;">405201</td> </tr> <tr> <td style="border: none;">Date of Conversion:</td> <td style="border: none;">10/30/06 JIM</td> </tr> </table>	TOWN OF:	LOUISVILLE	VILLAGE OF:	MASSENA	DISTRICT NO.:	405201	Date of Conversion:	10/30/06 JIM	<table style="width:100%; border: none;"> <tr> <td style="border: none;">SECTION NO.</td> <td style="border: none; font-size: 24pt;">9.082</td> </tr> <tr> <td style="border: none;">PROPERTY MAP</td> <td style="border: none;"></td> </tr> </table>	SECTION NO.	9.082	PROPERTY MAP	
International Boundary	—————	Denotes Common Owner	—————																																																																																							
County Boundary	—————	Railroad	—————																																																																																							
Town Boundary	—————	Water	—————																																																																																							
Village Boundary	—————	Block Limit Line	—————																																																																																							
Property or R/W Line	—————	Special District Line	—————																																																																																							
		Subdivision Lot Line	—————																																																																																							
Block No.	①																																																																																									
Parcel No.	27																																																																																									
Subdivision Lot No.	(10)																																																																																									
Deed Dimension	112'																																																																																									
Scaled Dimension	27'±																																																																																									
Deed Area	(27.3±)																																																																																									
Calculated Area	148.2A(c)																																																																																									
7																																																																																										
6																																																																																										
5																																																																																										
4																																																																																										
3																																																																																										
2																																																																																										
1																																																																																										
REVISIONS		DATE	BY																																																																																							
TOWN OF:	LOUISVILLE																																																																																									
VILLAGE OF:	MASSENA																																																																																									
DISTRICT NO.:	405201																																																																																									
Date of Conversion:	10/30/06 JIM																																																																																									
SECTION NO.	9.082																																																																																									
PROPERTY MAP																																																																																										