

LINE OF OFFICE OF ONTARIO, CANADA
 MASSENA, ST. LAWR. CO., STATE OF N.Y., U.S.A. TOWN

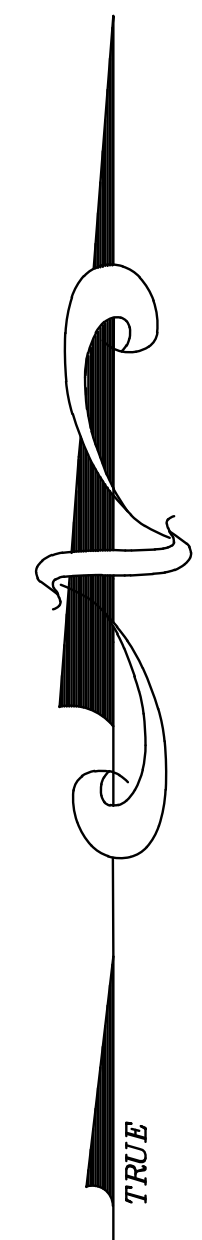
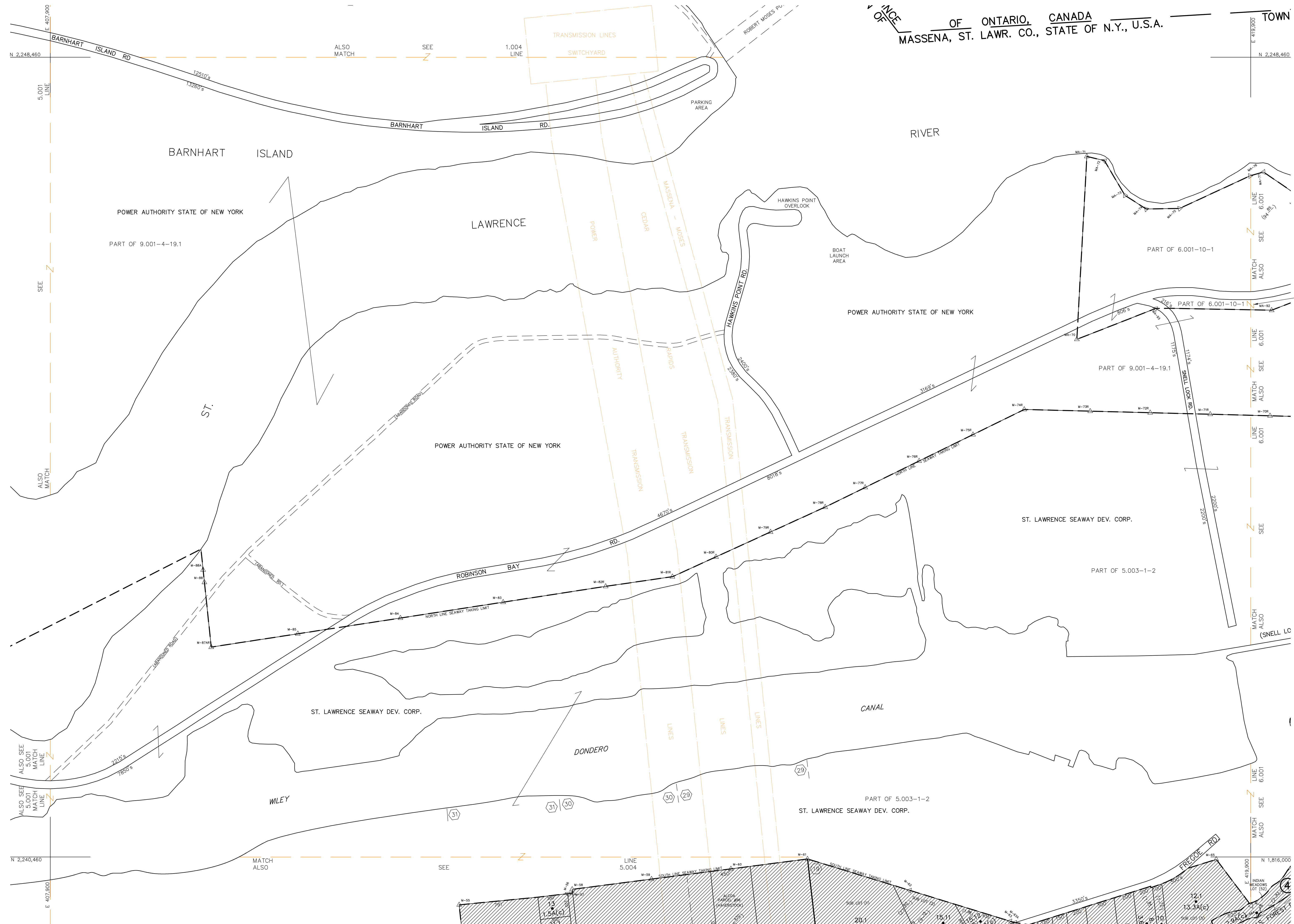

UNLESS DRAWN OTHERWISE, ALL PROPERTIES ARE WITHIN THE FOLLOWING DISTRICTS:

SCHOOL	405881	WATER	_____
FIRE	FR002	SEWER	_____
LIGHT	_____	AGRICULTURAL	_____

THIS MAP WAS PREPARED FOR TAX PURPOSES ONLY
 NOT TO BE USED FOR CONVEYANCE

NOTICE OF DISCLAIMER

This map represents a compilation of graphical and textual information from deeds and surveys, a planimetric base map, and digital conversions of hand drawn mylar maps. Errors and omissions can occur from each of these sources; each source represents a large number of records and originators of information. As a practical matter, the County does not warrant the accuracy or completeness of the information portrayed. The end user of these maps agrees to accept the data "as is" with the full knowledge that errors and omissions may exist, and to hold harmless the County for any damages that may result from an inappropriate use of these maps.

DRAWING LEGEND

International Boundary	_____	Denotes Common Owner Railroad	_____
County Boundary	_____	Water	_____
Town Boundary	_____	Block Limit Line	_____
Village Boundary	_____	Special District Line	_____
Property or R/W Line	_____	Subdivision Lot Line	_____

Block No.	①
Parcel No.	27
Subdivision Lot No.	(10)
Deed Dimension	112'
Scaled Dimension	27'
Deed Area	(27.3)
Calculated Area	148.2A(c)



ST. LAWRENCE COUNTY
NEW YORK
REAL PROPERTY
 COUNTY OFFICE BUILDING
 CANTON, NEW YORK 13617
 (315) 379-2272 OFFICE
 (315) 229-3222 FAX

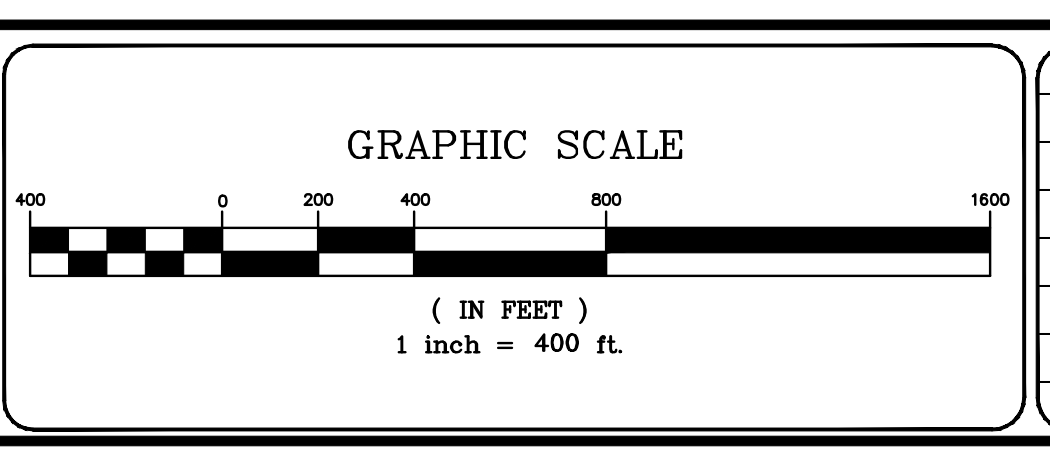

NO.	REVISIONS	DATE	BY
7			
6			
5			
4			
3			
2			
1			

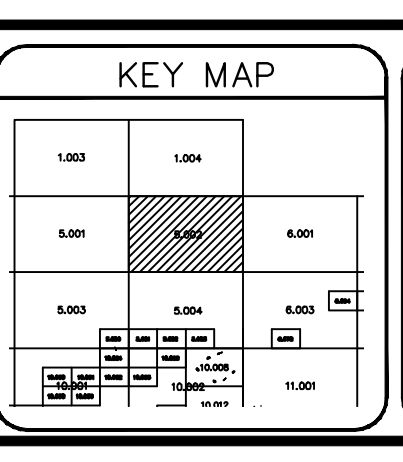

TOWN OF: **MASSENA**
 DISTRICT NO.: **405889**
 Date of Conversion: 03/01/09 LDC

SECTION NO.
5.002
 PROPERTY MAP