

NOTE: THE LOTS BY THE R.R. WERE TO BE PARALLEL WITH THE BOUNDARIES OF THE ORIGINAL FARM LOT AND NOT AN EXTENSION OF THE CAMP LOTS.

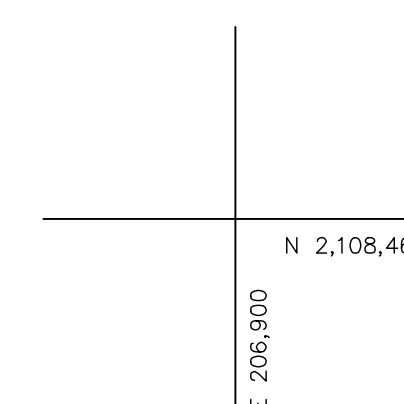
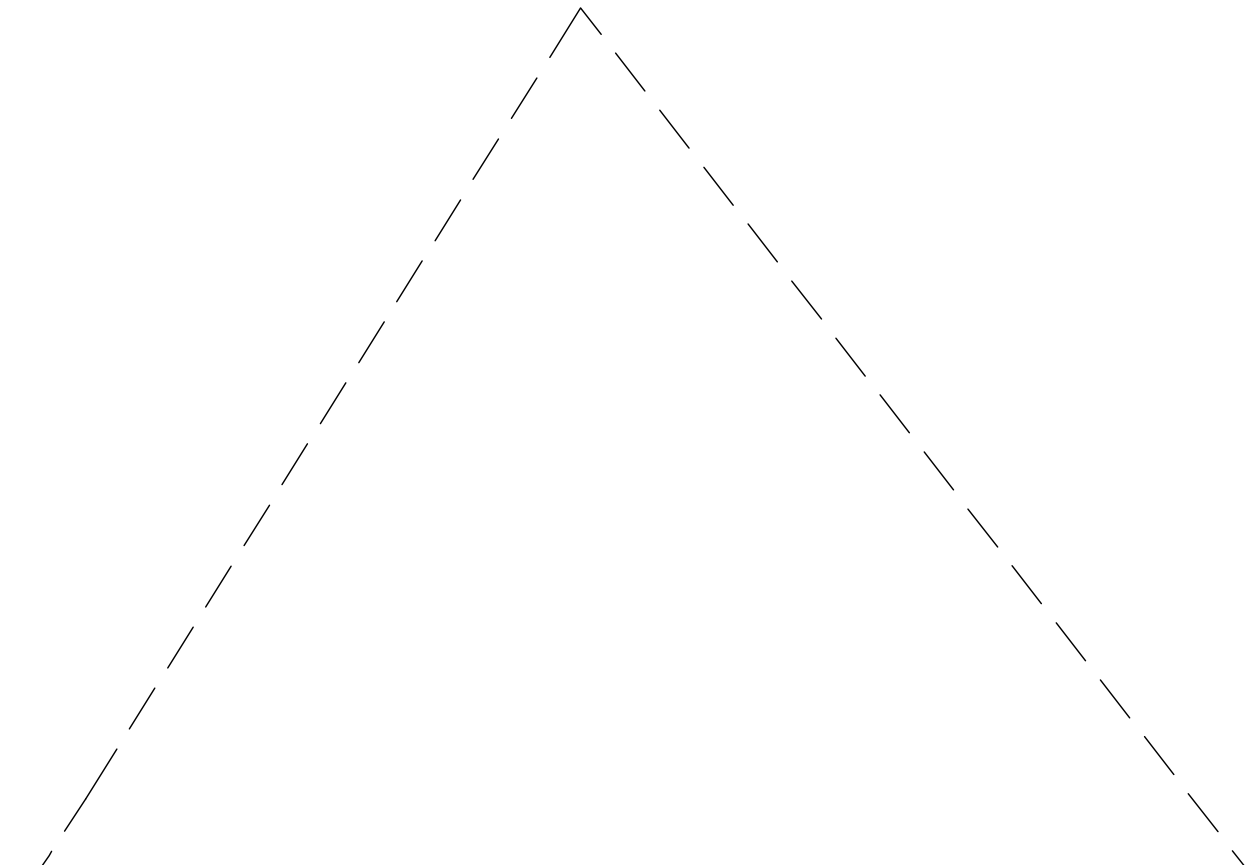

UNLESS DRAWN OTHERWISE, ALL PROPERTIES ARE WITHIN THE FOLLOWING DISTRICTS:

SCHOOL	400001	WATER	
FIRE	70007	SEWER	
LIGHT		AGRICULTURAL	

THIS MAP WAS PREPARED FOR TAX PURPOSES ONLY  
NOT TO BE USED FOR CONVEYANCE

<p><b>NOTICE OF DISCLAIMER</b></p> <p>This map represents a compilation of graphical and textual information from deeds and surveys, a planimetric base map, and digital conversions of hand drawn mylar maps. Errors and omissions can occur from each of these sources; each source represents a large number of records and originators of information. As a practical matter, the County does not warrant the accuracy or completeness of the information portrayed. The end user of these maps agrees to accept the data "as is" with the full knowledge that errors and omissions may exist, and to hold harmless the County for any damages that may result from an inappropriate use of these maps.</p>	<p><b>DRAWING LEGEND</b></p> <table border="0"> <tr> <td>International Boundary</td> <td>—————</td> <td>Denotes Common Owner</td> <td>Z</td> </tr> <tr> <td>County Boundary</td> <td>—————</td> <td>Railroad</td> <td>—————</td> </tr> <tr> <td>Town Boundary</td> <td>—————</td> <td>Water</td> <td>—————</td> </tr> <tr> <td>Village Boundary</td> <td>—————</td> <td>Block Limit Line</td> <td>—————</td> </tr> <tr> <td>Property or R/W Line</td> <td>—————</td> <td>Special District Line</td> <td>—————</td> </tr> <tr> <td></td> <td></td> <td>Subdivision Lot Line</td> <td>—————</td> </tr> </table>	International Boundary	—————	Denotes Common Owner	Z	County Boundary	—————	Railroad	—————	Town Boundary	—————	Water	—————	Village Boundary	—————	Block Limit Line	—————	Property or R/W Line	—————	Special District Line	—————			Subdivision Lot Line	—————	<table border="0"> <tr> <td>Block No.</td> <td>①</td> </tr> <tr> <td>Parcel No.</td> <td>27</td> </tr> <tr> <td>Subdivision Lot No.</td> <td>(10)</td> </tr> <tr> <td>Deed Dimension</td> <td>112'</td> </tr> <tr> <td>Scaled Dimension</td> <td>27'±</td> </tr> <tr> <td>Deed Area</td> <td>(27.3±)</td> </tr> <tr> <td>Calculated Area</td> <td>148.2A(c)</td> </tr> </table>	Block No.	①	Parcel No.	27	Subdivision Lot No.	(10)	Deed Dimension	112'	Scaled Dimension	27'±	Deed Area	(27.3±)	Calculated Area	148.2A(c)	 <p><b>ST. LAWRENCE COUNTY</b> NEW YORK <b>REAL PROPERTY</b> COUNTY OFFICE BUILDING CANTON, NEW YORK 13617 (315) 379-2272 OFFICE (315) 229-3222 FAX</p>	<p><b>GRAPHIC SCALE</b></p>  <p>( IN FEET ) 1 inch = 100 ft.</p>	<table border="1" style="width:100%; border-collapse: collapse;"> <tr><td>7</td><td></td><td></td><td></td></tr> <tr><td>6</td><td></td><td></td><td></td></tr> <tr><td>5</td><td></td><td></td><td></td></tr> <tr><td>4</td><td></td><td></td><td></td></tr> <tr><td>3</td><td></td><td></td><td></td></tr> <tr><td>2</td><td></td><td></td><td></td></tr> <tr><td>1</td><td></td><td></td><td></td></tr> <tr><td></td><td>REVISIONS</td><td>DATE</td><td>BY</td></tr> </table>	7				6				5				4				3				2				1					REVISIONS	DATE	BY	<p><b>KEY MAP</b></p> 	<p>TOWN OF: <b>MORRISTOWN</b></p> <p>DISTRICT NO.: <b>406089</b></p> <p>Date of Conversion: 11/10/08 JIM</p>	<p>SECTION NO.</p> <p style="font-size: 2em;"><b>70.061</b></p> <p>PROPERTY MAP</p>
International Boundary	—————	Denotes Common Owner	Z																																																																											
County Boundary	—————	Railroad	—————																																																																											
Town Boundary	—————	Water	—————																																																																											
Village Boundary	—————	Block Limit Line	—————																																																																											
Property or R/W Line	—————	Special District Line	—————																																																																											
		Subdivision Lot Line	—————																																																																											
Block No.	①																																																																													
Parcel No.	27																																																																													
Subdivision Lot No.	(10)																																																																													
Deed Dimension	112'																																																																													
Scaled Dimension	27'±																																																																													
Deed Area	(27.3±)																																																																													
Calculated Area	148.2A(c)																																																																													
7																																																																														
6																																																																														
5																																																																														
4																																																																														
3																																																																														
2																																																																														
1																																																																														
	REVISIONS	DATE	BY																																																																											