

UNLESS DRAWN OTHERWISE, ALL PROPERTIES ARE WITHIN THE FOLLOWING DISTRICTS:
 SCHOOL 406489, 406501
 FIRE 70002
 LIGHT 70002
 WATER 70002
 SEWER 70002
 AGRICULTURAL 70002

THIS MAP WAS PREPARED FOR TAX PURPOSES ONLY
 NOT TO BE USED FOR CONVEYANCE

NOTICE OF DISCLAIMER
 This map represents a compilation of graphical and textual information from deeds and surveys, a planimetric base map, and digital conversions of hand drawn mylar maps. Errors and omissions can occur from each of these sources; each source represents a large number of records and originators of information. As a practical matter, the County does not warrant the accuracy or completeness of the information portrayed. The end user of these maps agrees to accept the data "as is" with the full knowledge that errors and omissions may exist, and to hold harmless the County for any damages that may result from an inappropriate use of these maps.

DRAWING LEGEND
 International Boundary
 County Boundary
 Town Boundary
 Village Boundary
 Property or R/W Line
 Denotes Common Owner
 Railroad
 Water
 Block Limit Line
 Special District Line
 Subdivision Lot Line

Block No. 1
 Parcel No. 27
 Subdivision Lot No. (10)
 Deed Dimension 112'
 Scaled Dimension 27'
 Deed Area (27.3)
 Calculated Area 148.2A(c)

ST. LAWRENCE COUNTY
 NEW YORK
 REAL PROPERTY
 COUNTY OFFICE BUILDING
 CANTON, NEW YORK 13617
 (315) 379-2272 OFFICE
 (315) 229-3222 FAX

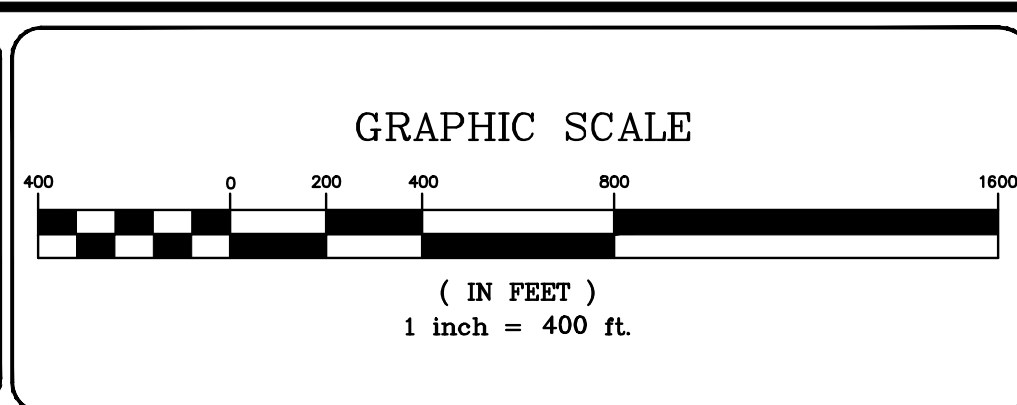

NO.	REVISIONS	DATE	BY
7			
6			
5			
4			
3			
2			
1			

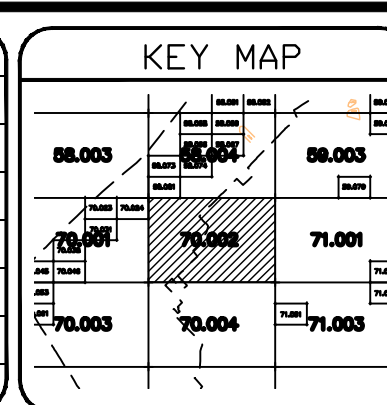

TOWN OF: OSWEGATCHIE
 DISTRICT NO.: 406489
 Date of Conversion: 11/1/2010 LDC

SECTION NO.
 70.002
 PROPERTY MAP