

UNLESS DRAWN OTHERWISE, ALL PROPERTIES ARE WITHIN THE FOLLOWING DISTRICTS:

SCHOOL 405601, 406201	WATER
FIRE 70008	SEWER
LIGHT	AGRICULTURAL

THIS MAP WAS PREPARED FOR TAX PURPOSES ONLY
NOT TO BE USED FOR CONVEYANCE

NOTICE OF DISCLAIMER

This map represents a compilation of graphical and textual information from deeds and surveys, a planimetric base map, and digital conversions of hand drawn mylar maps. Errors and omissions can occur from each of these sources; each source represents a large number of records and originators of information. As a practical matter, the County does not warrant the accuracy or completeness of the information portrayed. The use of these maps agrees to accept the data "as is" with the full knowledge that errors and omissions may exist, and to hold harmless the County for any damages that may result from an inappropriate use of these maps.

DRAWING LEGEND

International Boundary	—————	Denotes Common Owner	Z
County Boundary	—————	Railroad	—————
Town Boundary	—————	Water	—————
Village Boundary	—————	Block Limit Line	—————
Property or R/W Line	—————	Special District Line	—————
		Subdivision Lot Line	—————

Block No.	①
Parcel No.	27
Subdivision Lot No.	(10)
Deed Dimension	112'
Scaled Dimension	27'
Deed Area	(27.3)
Calculated Area	148.2A(c)

ST. LAWRENCE COUNTY
NEW YORK
REAL PROPERTY

COUNTY OFFICE BUILDING
CANTON, NEW YORK 13617
(315) 379-2272 OFFICE
(315) 229-3222 FAX

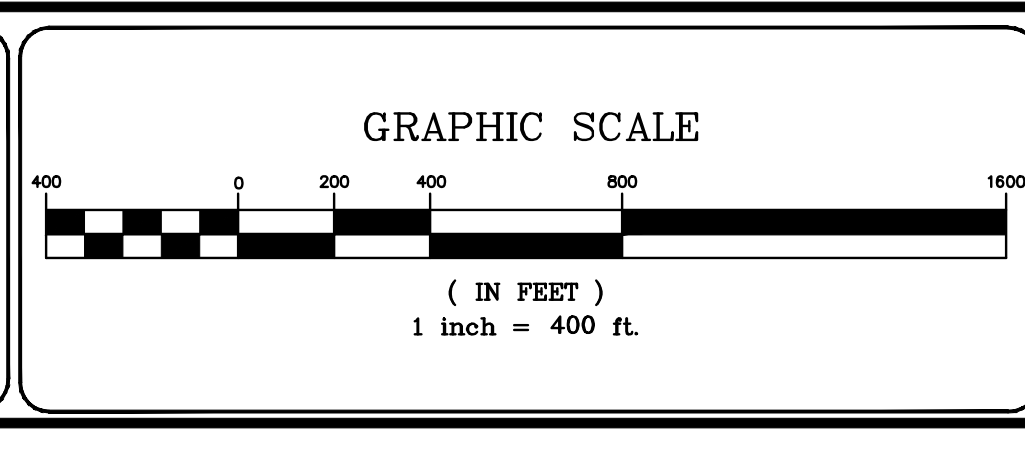

REVISIONS	DATE	BY
7		
6		
5		
4		
3		
2		
1		

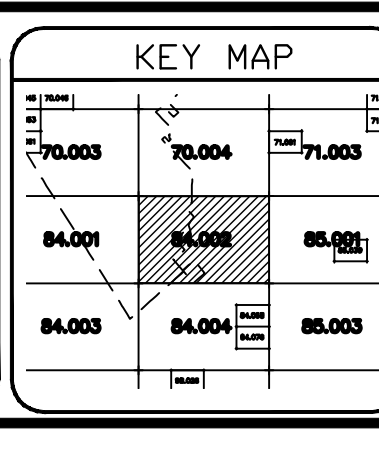

TOWN OF: OSWEGATCHIE
DISTRICT NO.: 406489
Date of Conversion: 11/1/2010 LDC

SECTION NO.
84.002
PROPERTY MAP