

N 2,202,460

N 2,200,460

N 2,198,460

N 2,196,460

N 2,194,460

N 2,192,460

N 2,190,460

E 3,059,900

E 3,059,900

E 3,119,900

E 3,149,900

E 3,179,900

NOTE: A SERIES OF SQUARE OR RECTANGULAR PARCELS (OF LESS THAN ONE ACRE) HAVING TWO OR FOUR EQUAL SIDES ARE USUALLY DIMENSIONED ON THE FIRST AND LAST LINE OF THE SERIES ONLY. ALL THE OTHER PARALLEL LINES IN THIS SERIES OF LOTS ARE TO BE CONSIDERED AS BEING THE SAME LENGTH.

APPROVED BY NEW YORK BOARD OF EQUALIZATION AND ASSESSMENT

CASE NO. 1549 J TAGGART (AUTHORIZED SIGNATURE) JUNE 8, 1979

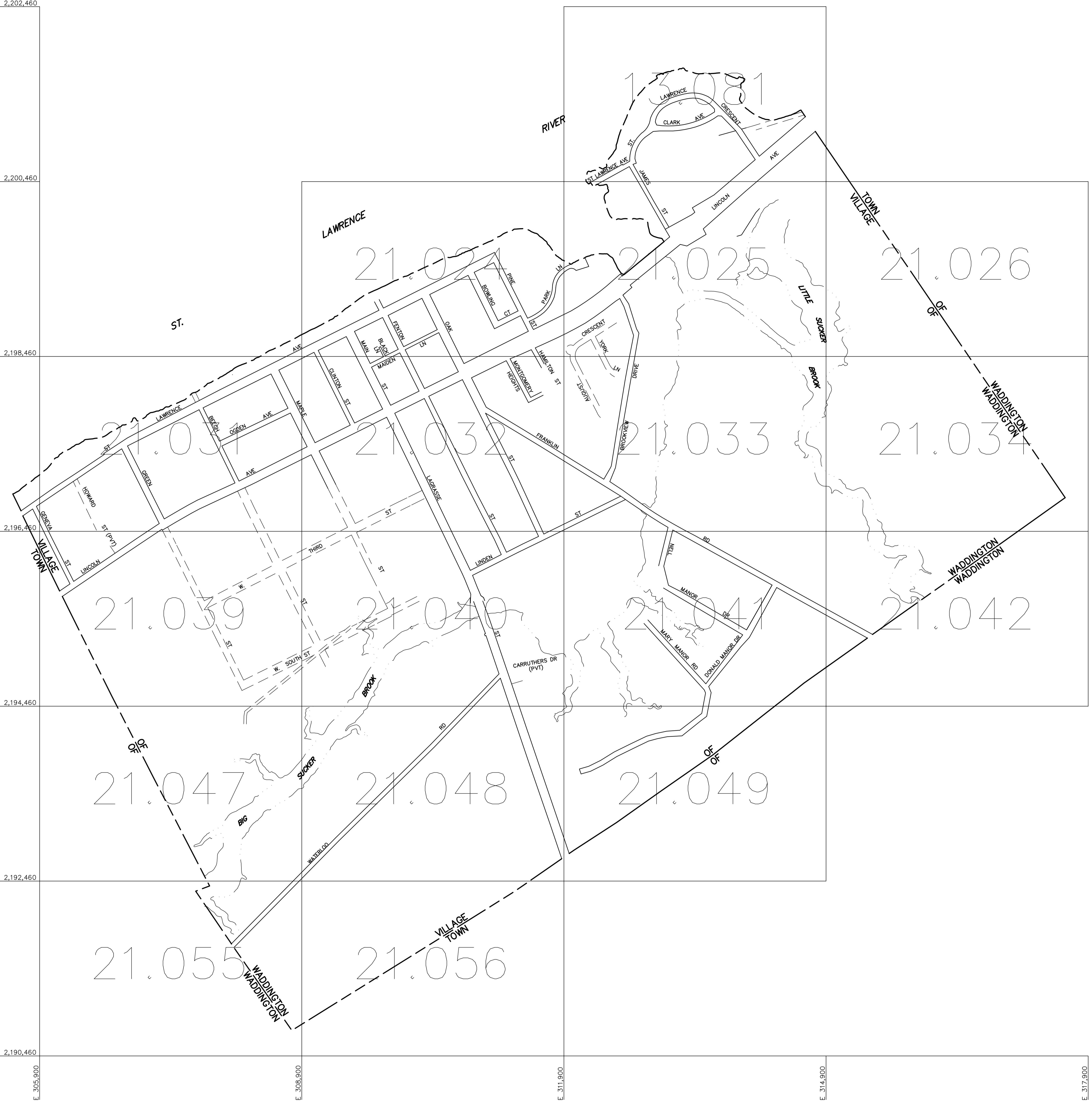
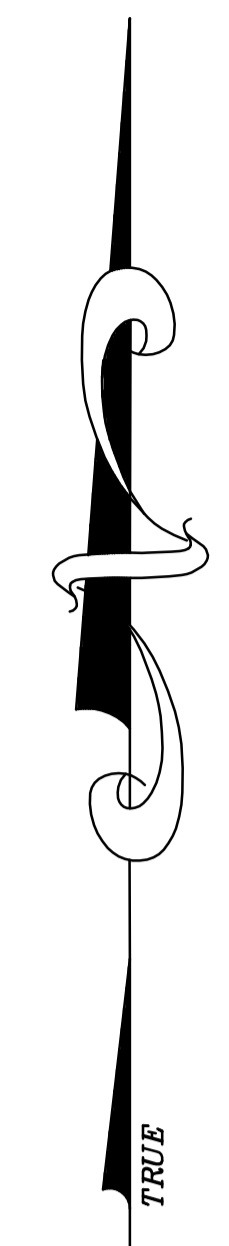

THIS MAP WAS PREPARED FOR TAX PURPOSES ONLY NOT TO BE USED FOR CONVEYANCE

NOTICE OF DISCLAIMER

This map represents a compilation of graphical and textual information from deeds and surveys, a planimetric base map, and digital conversions of hand drawn mylar maps. Errors and omissions can occur from each of these sources; each source represents a large number of records and originators of information. As a practical matter, the County does not warrant the accuracy or completeness of the information portrayed. The end user of these maps agrees to accept the data "as is" with the full knowledge that errors and omissions may exist, and to hold harmless the County for any damages that may result from an inappropriate use of these maps.

DRAWING LEGEND

- International Boundary
- County Boundary
- Town Boundary
- Village Boundary
- Property or R/W Line
- Denotes Common Owner
- Railroad
- Water
- Block Limit Line
- Special District Line
- Subdivision Lot Line

Block No.	27
Parcel No.	112
Subdivision Lot No.	27 ³
Deed Dimension	27 ³
Scaled Dimension	27 ³
Deed Area	148.2A(c)
Calculated Area	148.2A(c)

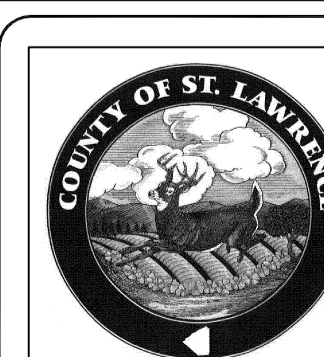

ST. LAWRENCE COUNTY NEW YORK REAL PROPERTY COUNTY OFFICE BUILDING CANTON, NEW YORK 13617 (315) 379-2272 OFFICE (315) 229-3222 FAX

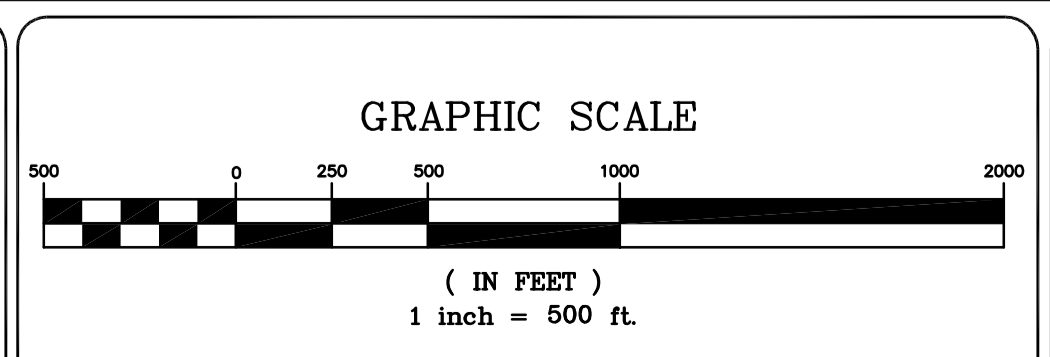

7			
6			
5			
4			
3			
2			
1			
	REVISIONS	DATE	BY

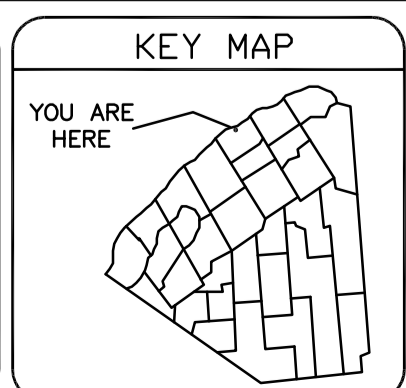

VILLAGE OF: WADDINGTON DISTRICT NO.: 408201 Date of Conversion: 04/09/07 JIM

SECTION NO. INDEX PROPERTY MAP