

N 2,012,460  
 N 2,010,460  
 N 2,008,460  
 N 2,006,460  
 N 2,004,460  
 N 2,002,460  
 N 2,000,460

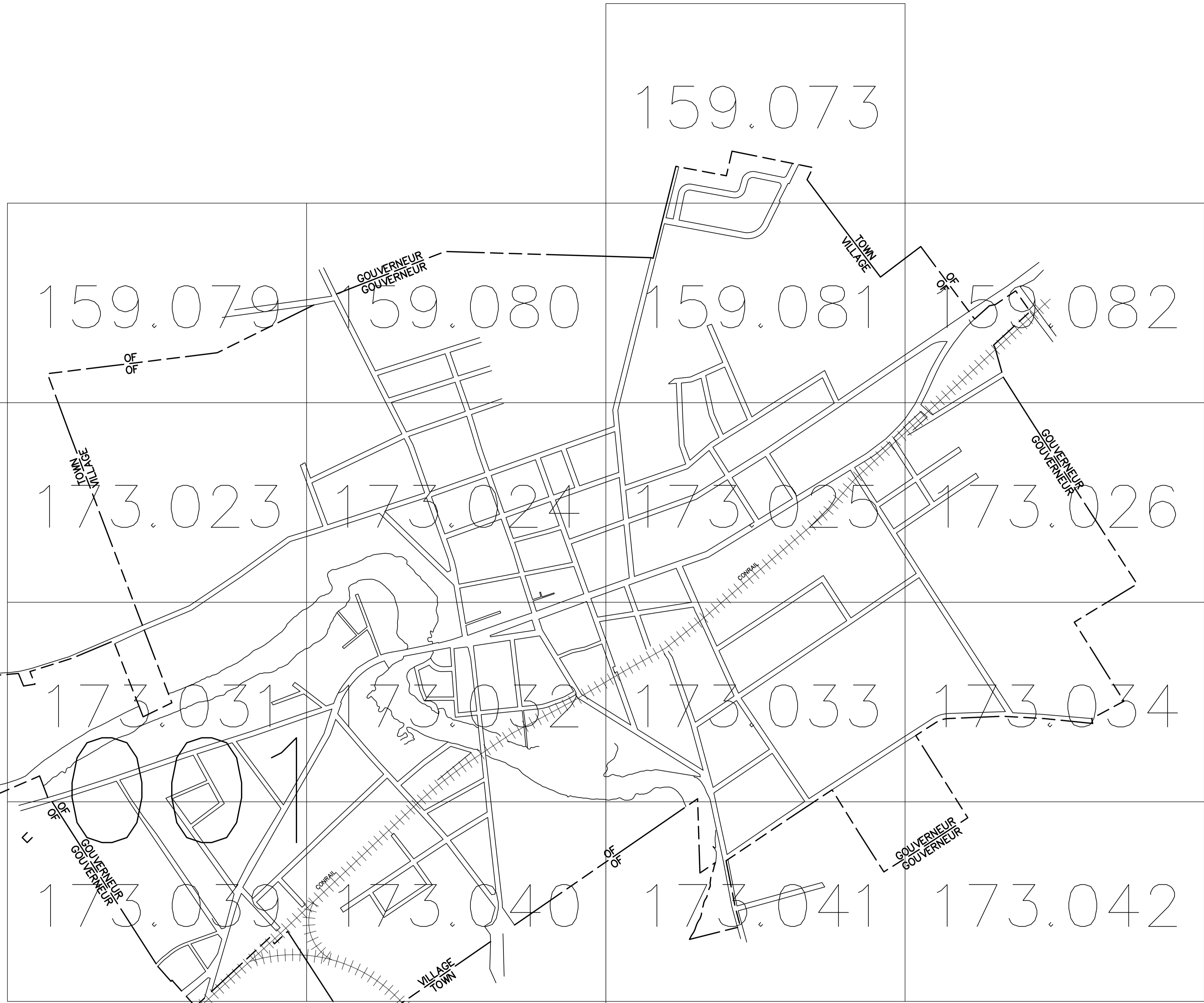
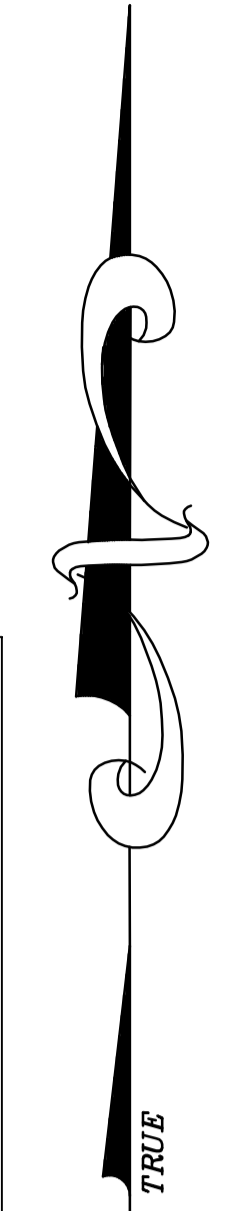

NOTE: A SERIES OF SQUARE OR RECTANGULAR PARCELS (OF LESS THAN ONE ACRE) HAVING TWO OR FOUR EQUAL SIDES ARE USUALLY DIMENSIONED ON THE FIRST AND LAST LINE OF THE SERIES ONLY; ALL THE OTHER PARALLEL LINES IN THIS SERIES OF LOTS ARE TO BE CONSIDERED AS BEING THE SAME LENGTH.

APPROVED BY NEW YORK BOARD OF EQUALIZATION AND ASSESSMENT  
 CASE NO. 1549 J TAGGART (AUTHORIZED SIGNATURE) JUNE 8, 1979

UNLESS DRAWN OTHERWISE, ALL PROPERTIES ARE WITHIN THE FOLLOWING DISTRICTS:  
 SCHOOL 404001 WATER  
 FIRE SEWER  
 LIGHT AGRICULTURAL

THIS MAP WAS PREPARED FOR TAX PURPOSES ONLY  
 NOT TO BE USED FOR CONVEYANCE

**NOTICE OF DISCLAIMER**  
 This map represents a compilation of graphical and textual information from deeds and surveys, a planimetric base map, and digital conversions of hand drawn master maps. Errors and omissions can occur from each of these sources; each source represents a large number of records and originators of information. As a practical matter, the County does not warrant the accuracy or completeness of the information portrayed. The end user of these maps agrees to accept the data "as is" with the full knowledge that errors and omissions may exist, and to hold harmless the County for any damages that may result from an inappropriate use of these maps.

**DRAWING LEGEND**

International Boundary	—————	Denotes Common Owner	—————
County Boundary	—————	Railroad	—————
Town Boundary	—————	Water	—————
Village Boundary	—————	Block Limit Line	—————
Property or R/W Line	—————	Special District Line	—————
		Subdivision Lot Line	—————

Block No.	27
Parcel No.	112
Subdivision Lot No.	27 <sup>3</sup>
Deed Dimension	27 <sup>3</sup>
Scaled Dimension	27 <sup>3</sup>
Deed Area	148.2A(c)
Calculated Area	148.2A(c)

**ST. LAWRENCE COUNTY**  
**NEW YORK**  
**REAL PROPERTY**  
 COUNTY OFFICE BUILDING  
 CANTON, NEW YORK 13617  
 (315) 379-2272 OFFICE  
 (315) 229-3222 FAX

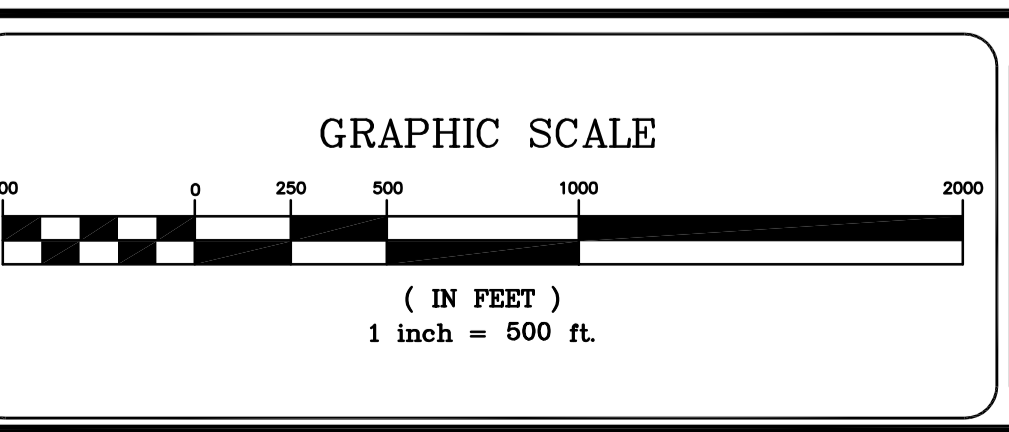

REVISIONS	DATE	BY
7		
6		
5		
4		
3		
2		
1		

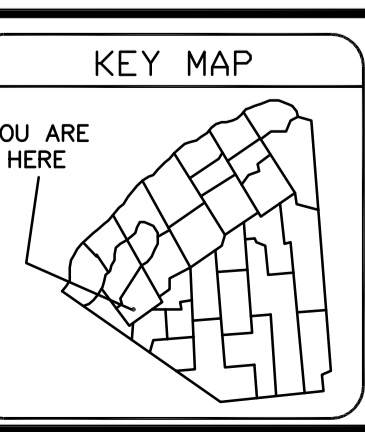

TOWN OF: **GOUVERNEUR**  
 VILLAGE OF: **GOUVERNEUR**  
 DISTRICT NO.: **404001**  
 Date of Conversion: 12/19/06 JIM

SECTION NO.  
**INDEX**  
 PROPERTY MAP