

NOTE: DUE TO SPACE RESTRAINTS, NOT ALL TOWN ROAD NAMES APPEAR ON THIS INDEX MAP. THE FOLLOWING IS A LIST OF THESE STREETS.

- | | |
|--------------------------------|---------------------------|
| 1) AMO ST. | 224.045, 224.046 |
| 2) BACKUS ST. | 224.038 |
| 3) CATHERINE ST. | 224.030, 224.038 |
| 4) CESSNA DR. | 224.046 |
| 5) CHERRY HILL RD. | 223.036 |
| 6) CHURCH ST. | 201.036, 202.029 |
| 7) COLBY ST. | 224.037, 224.045 |
| 8) EDDY RD. | 225.057, 225.065 |
| 9) FIFTH ST. | 225.071 |
| 10) FIRE RD. | 202.000, 202.029 |
| 11) FIRST ST. | 225.072 |
| 12) FOREST VIEW RD. | 224.046 |
| 13) FOURTH ST. | 225.071, 225.072 |
| 14) FRONT ST. | 225.072 |
| 15) GORE ST. | 223.000, 223.036, 224.029 |
| 16) GREGG ST. | 224.045 |
| 17) GRIFFIN AV. | 224.038, 224.046 |
| 18) HALL AV. | 224.021, 224.029 |
| 19) HAMELE ST. | 225.072 |
| 20) HANKS RD. | 223.044 |
| 21) HANSON ST. | 202.000, 202.029 |
| 22) KENNY ST. | 224.028 |
| 23) KERR ST. | 224.038, 224.046 |
| 24) MARSHALL AV. | 224.030 |
| 25) MORAWK DR. | 224.046 |
| 26) OLD RT. 3/FINE | 202.000 |
| 27) OLD S.H. 58 | 201.002 |
| 28) POTTER AV. | 224.029, 224.030 |
| 29) PLUMMERVILLE RD.(PVT. RD.) | 223.010 |
| 30) REIMER RD. | 224.045, 224.037 |
| 31) RIVER ST. | 225.071, 225.072 |
| 32) RIVER RD. | 213.051 |
| 33) SCHOOL ST. | 224.029 |
| 34) SCOTT'S POINT RD. | 224.029, 224.030 |
| 35) SECOND ST. | 225.072 |
| 36) SHELTON CREST RD. | 224.030, 224.038 |
| 37) SIXTH ST. | 225.071 |
| 38) SPRING ST. | 202.029 |
| 39) SWISS POINT RD. | 223.036 |
| 40) THIRD ST. | 225.072 |
| 41) VALLEY VIEW DR. | 224.046 |

THIS IS A SUPPLEMENTAL LIST OF TOWN ROADS.

- | | |
|---------------------------------|------------------|
| 1) BENSON MINES GOLF COURSE RD. | 224.030 |
| 2) COLTON LN. | 224.038 |
| 3) MAIN ST. | 225.000, 225.071 |
| 4) MILL RD. | 213.051 |
| 5) FINE ST. | 224.038 |

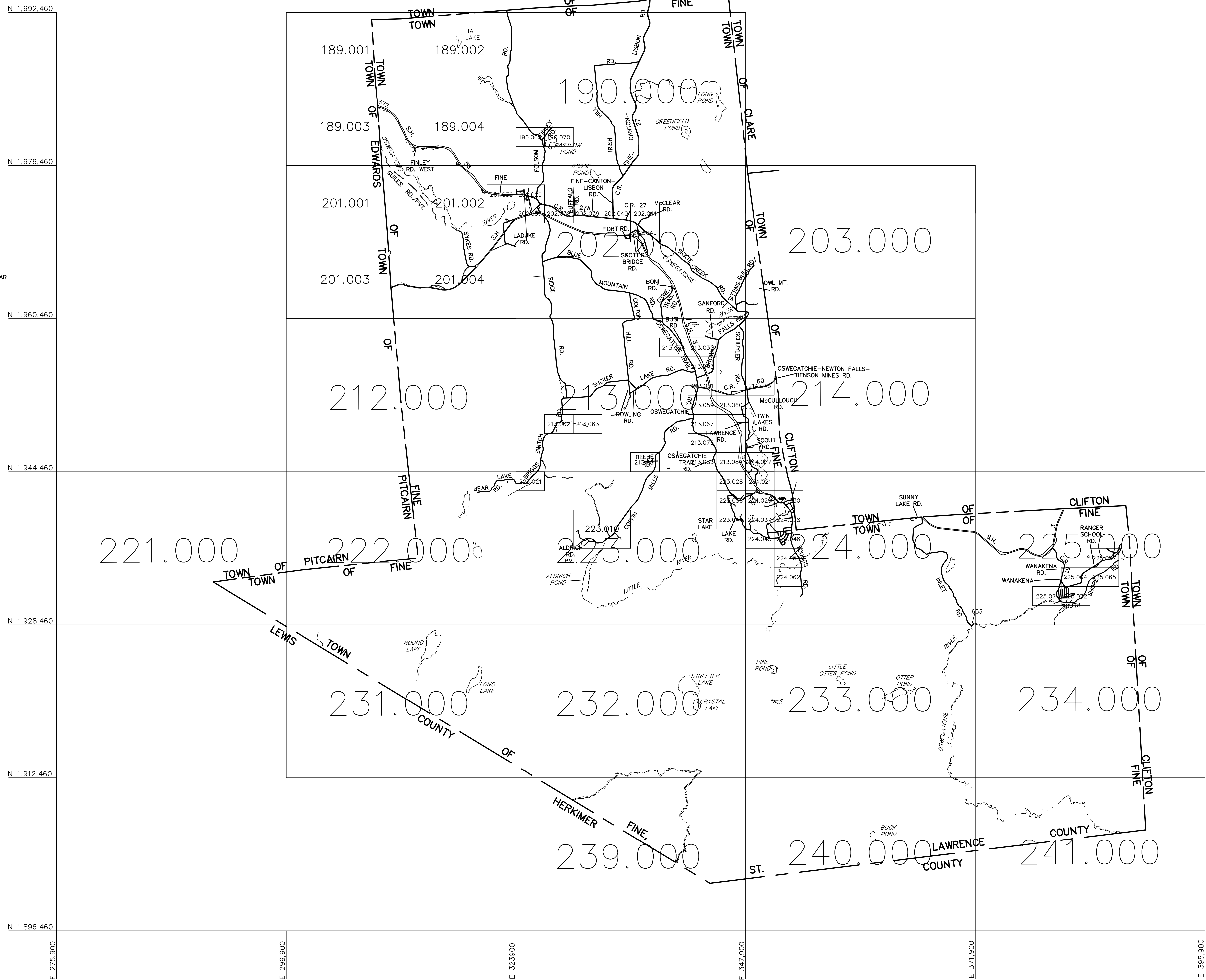

THIS MAP WAS PREPARED FOR TAX PURPOSES ONLY
NOT TO BE USED FOR CONVEYANCE

<p>NOTICE OF DISCLAIMER</p> <p>This map represents a compilation of graphical and textual information from deeds and surveys, a planimetric base map, and digital conversions of hand drawn maps. Errors and omissions can occur from each of these sources; each source represents a large number of records and originators of information. As a practical matter, the County does not warrant the accuracy or completeness of the information portrayed. The end user of these maps agrees to accept the data "as is" with the full knowledge that errors and omissions may exist, and to hold harmless the County for any damages that may result from an inappropriate use of these maps.</p>	<p>DRAWING LEGEND</p> <table border="0"> <tr><td>International Boundary</td><td>---</td></tr> <tr><td>County Boundary</td><td>---</td></tr> <tr><td>Town Boundary</td><td>---</td></tr> <tr><td>Village Boundary</td><td>---</td></tr> <tr><td>Property or R/W Line</td><td>---</td></tr> </table> <table border="0"> <tr><td>Denotes Common Owner</td><td>Z</td></tr> <tr><td>Railroad</td><td>====</td></tr> <tr><td>Water</td><td>~~~~</td></tr> <tr><td>Block Limit Line</td><td>---</td></tr> <tr><td>Special District Line</td><td>---</td></tr> <tr><td>Subdivision Lot Line</td><td>---</td></tr> </table> <table border="0"> <tr><td>Block No.</td><td>1</td></tr> <tr><td>Parcel No.</td><td>27</td></tr> <tr><td>Subdivision Lot No.</td><td>(10)</td></tr> <tr><td>Deed Dimension</td><td>112</td></tr> <tr><td>Deed Area</td><td>27.8</td></tr> <tr><td>Calculated Area</td><td>27.33</td></tr> <tr><td></td><td>148.2A(c)</td></tr> </table>	International Boundary	---	County Boundary	---	Town Boundary	---	Village Boundary	---	Property or R/W Line	---	Denotes Common Owner	Z	Railroad	====	Water	~~~~	Block Limit Line	---	Special District Line	---	Subdivision Lot Line	---	Block No.	1	Parcel No.	27	Subdivision Lot No.	(10)	Deed Dimension	112	Deed Area	27.8	Calculated Area	27.33		148.2A(c)	<p>ST. LAWRENCE COUNTY NEW YORK REAL PROPERTY COUNTY OFFICE BUILDING CANTON, NEW YORK 13617 (315) 379-2272 OFFICE (315) 229-3222 FAX</p>	<p>GRAPHIC SCALE</p> <p>(IN FEET) 1 inch = 5000ft.</p>	<table border="1" style="width:100%; border-collapse: collapse;"> <tr><td>7</td><td></td><td></td></tr> <tr><td>6</td><td></td><td></td></tr> <tr><td>5</td><td></td><td></td></tr> <tr><td>4</td><td></td><td></td></tr> <tr><td>3</td><td></td><td></td></tr> <tr><td>2</td><td></td><td></td></tr> <tr><td>1</td><td></td><td></td></tr> </table> <p>REVISIONS DATE BY</p>	7			6			5			4			3			2			1			<p>KEY MAP</p> <p>YOU ARE HERE</p>	<table border="1" style="width:100%; border-collapse: collapse;"> <tr><td>TOWN OF:</td><td>FINE</td></tr> <tr><td>DISTRICT NO.:</td><td>403600</td></tr> <tr><td>Date of Conversion:</td><td>02/23/2010 JIM</td></tr> </table>	TOWN OF:	FINE	DISTRICT NO.:	403600	Date of Conversion:	02/23/2010 JIM	<p>SECTION NO.</p> <p style="font-size: 2em; text-align: center;">INDEX</p> <p>PROPERTY MAP</p>
International Boundary	---																																																																					
County Boundary	---																																																																					
Town Boundary	---																																																																					
Village Boundary	---																																																																					
Property or R/W Line	---																																																																					
Denotes Common Owner	Z																																																																					
Railroad	====																																																																					
Water	~~~~																																																																					
Block Limit Line	---																																																																					
Special District Line	---																																																																					
Subdivision Lot Line	---																																																																					
Block No.	1																																																																					
Parcel No.	27																																																																					
Subdivision Lot No.	(10)																																																																					
Deed Dimension	112																																																																					
Deed Area	27.8																																																																					
Calculated Area	27.33																																																																					
	148.2A(c)																																																																					
7																																																																						
6																																																																						
5																																																																						
4																																																																						
3																																																																						
2																																																																						
1																																																																						
TOWN OF:	FINE																																																																					
DISTRICT NO.:	403600																																																																					
Date of Conversion:	02/23/2010 JIM																																																																					